

2010-00210001-000

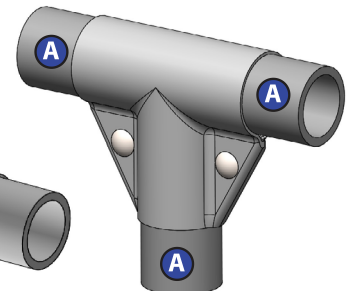

2010-00110001-000

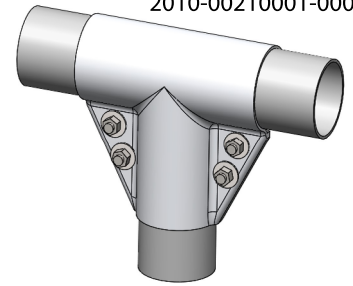
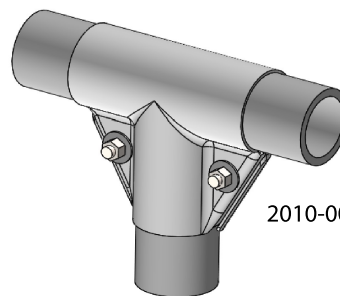

PIPE SIZE A	B	C	D	E	F	G	MATERIAL ³ THICKNESS	MATERIAL ³	FINISH ¹	# FASTENERS	Wt. (Lbs)	ORDERING PART NUMBER ²
2.375	6.00	5.57	.50	.43	.53	.388	.090 (13 GA)	STEEL	NO FINISH	2	1.95	2010-00110001-001
2.375	6.00	5.57	.50	.43	.53	.388	.090 (13 GA)	STEEL	GALVANIZED	2	1.95	2010-00110001-002
2.875	7.25	7.02	.50	.54	.51	.388	.105 (12 GA)	STEEL	NO FINISH	4	3.43	2010-00210001-001
2.875	7.25	7.02	.50	.54	.51	.388	.105 (12 GA)	STEEL	GALVANIZED	4	3.43	2010-00210001-002

1. FINIISH:

Available in HDG (hot dipped galvanized) and available with no finish. Galvanized finish per ASTM A153 and ASTM A123.

2. PART NUMBER; 2010-00110001-001:

2010 signifies assembly of connector/s and corresponding hardware (bolts, washers and nuts).

-001 signifies nominal 2" pipe diameter (OD 2.375"), -002 signifies nominal 2 1/2" pipe diameter (OD 2.875")

10001 signifies a unique part number, PIPE TEE.

-001 signifies the part finish, PLAIN, NO FINISH, -002 signifies the part finish, HDG (hot dipped galvanized).

3. MATERIAL:

1008 CR Steel

4. INSTALLATION:

For proper installation use 2 or 4 - 3/8-16 UNC minimum SAE Grade 5 steel bolts, washers and nuts or equivalent. Bolts can be either carriage or hex head type. Torque bolts evenly to 25 ft.-lbs. Avoid over tightening and use the supplied bolts, nuts and washers or equivalent.

5. DIMENSIONS:

All dimensions are in inches.