

# Product Engineering / Structural Pipe Connectors

## 90 DEGREE 2010-00010012-000

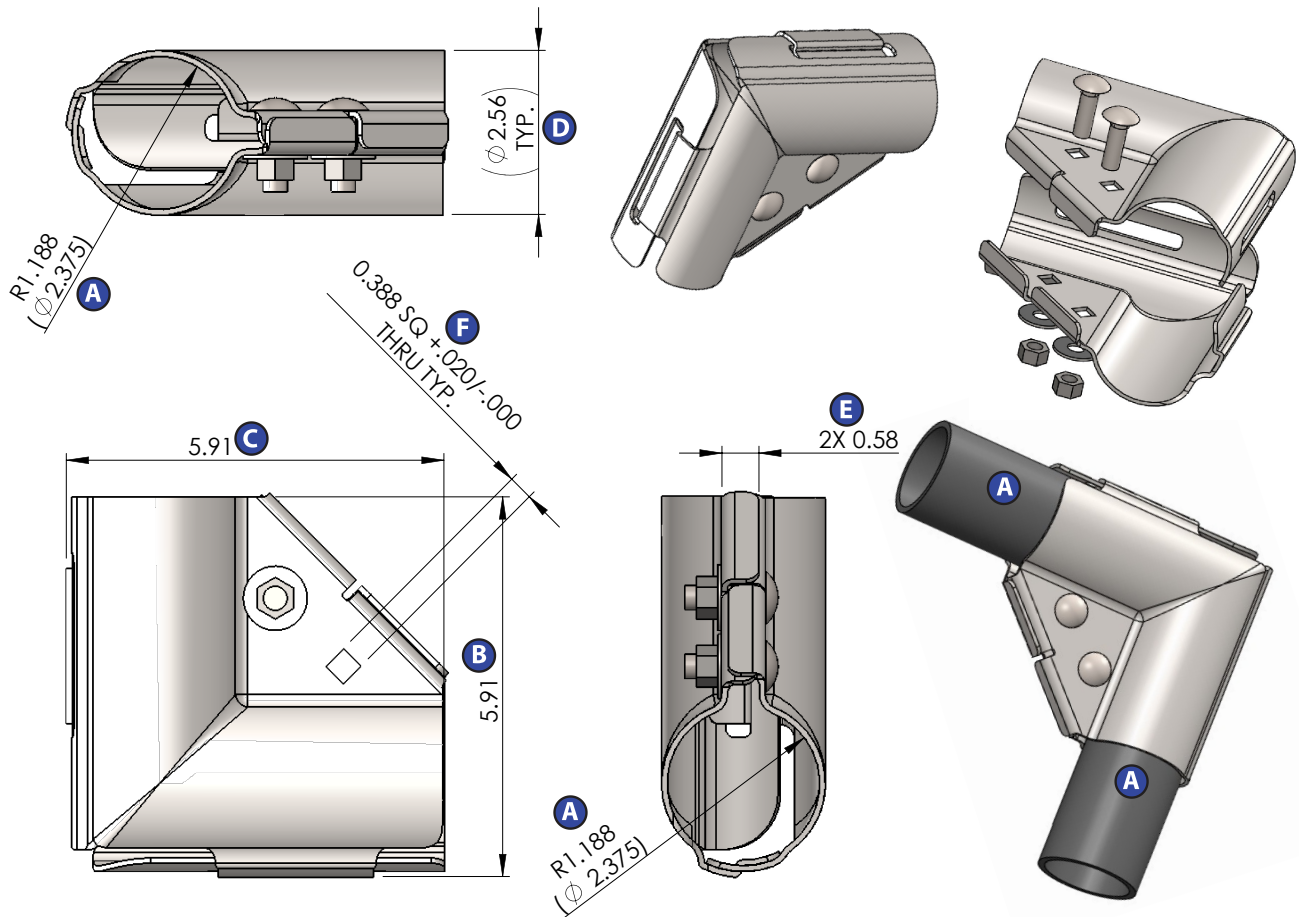

PIPE SIZE A	B	C	D	E	F	MATERIAL <sup>3</sup> THICKNESS	MATERIAL <sup>3</sup>	FINISH <sup>1</sup>	# FASTENERS	Wt. (Lbs)	ORDERING PART NUMBER <sup>2</sup>
2.375	5.91	5.91	2.56	.58	.388	.090 (13 GA)	STEEL	NO FINISH	2	2.18	2010-00110012-001
2.375	5.91	5.91	2.56	.58	.388	.090 (13 GA)	STEEL	GALVANIZED	2	2.18	2010-00110012-002
2.875	6.50	6.50	3.10	.58	.388	.105 (12 GA)	STEEL	NO FINISH	2	3.20	2010-00210012-001
2.875	6.50	6.50	3.10	.58	.388	.105 (12 GA)	STEEL	GALVANIZED	2	3.20	2010-00210012-002

### 1. FINISH:

Available in HDG (hot dipped galvanized) and available with no finish. Galvanized finish per ASTM A153 and ASTM A123.

### 2. PART NUMBER; 2010-00110012-001:

2010 signifies assembly of connector/s and corresponding hardware (bolts, washers and nuts).

-001 signifies nominal 2" pipe diameter (OD 2.375"), -002 signifies nominal 2 1/2" pipe diameter (OD 2.875")

10012 signifies a unique part number, 90 DEGREE.

-001 signifies the part finish, PLAIN, NO FINISH, -002 signifies the part finish, HDG (hot dipped galvanized).

### 3. ORDERING:

The ordering part number consists of 2 - 90 degree halves and 2 Grade 5 bolts, washers and nuts.

### 4. MATERIAL:

1008 CR Steel.

### 5. INSTALLATION:

For proper installation use 2 - 3/8 x 1 1/4 - 16 UNC minimum SAE Grade 5 steel bolts, washers and nuts or equivalent. Bolts can be either carriage or hex head type. Torque bolts evenly to 25 ft.-lbs. Avoid over tightening and use the supplied bolts, nuts and washers or equivalent.

### 6. DIMENSIONS:

All dimensions are in inches.